



**OSBORNE**  
AGRI-AIDE® Ventilation

RLX-0607\_D

## FC3000 CUPOLA *Installation Instructions*

1. Remove the parts from the packaging materials. There will be three parts: two cupola halves and a hardware packet. A pop rivet gun is required for assembly.
2. Clean the mating flanges of each cupola half. Take from the hardware packet the 6 oz. tube of caulking and apply a generous bead of caulking to the flange of one of the halves as shown on the illustration. Slide the halves together and line up the pre-drilled rivet holes. Insert the pop rivets in the holes with the washers on the back side and using a pop rivet gun, set the rivets.
3. Install the four snap plugs in the pre-drilled holes. Let the cupola set until the caulking has cured. The cupola is then ready for installation.

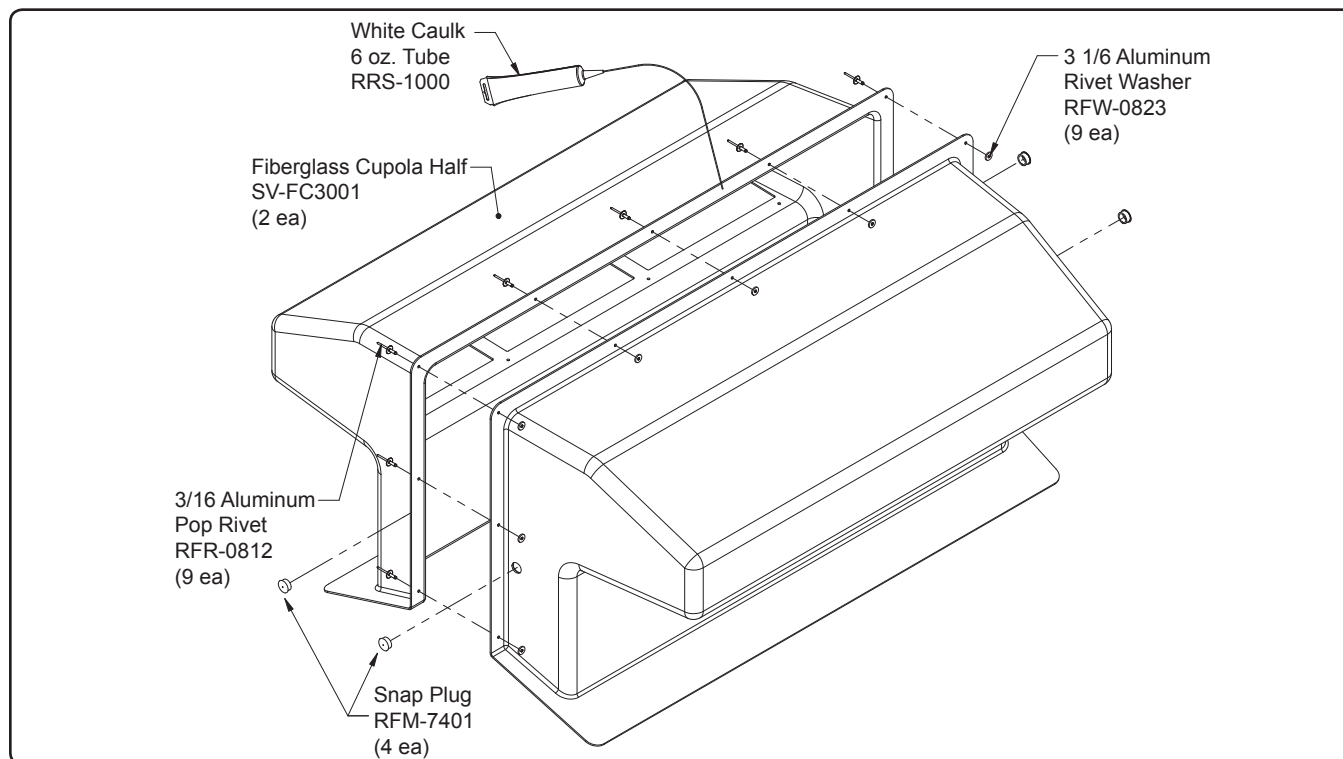

**OSBORNE**  
INDUSTRIES INC.

P.O. Box 388 • Osborne, KS 67473 U.S.A.  
Phone: 1-800-255-0316 • Fax: 1-785-346-2194  
sales@osborne-ind.com • www.osbornelivestockequipment.com